

AUDITORIUM SERIES

R25

ANNIVERSARY

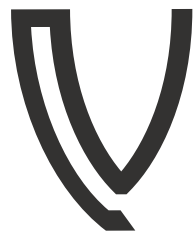

LIVING VOICE

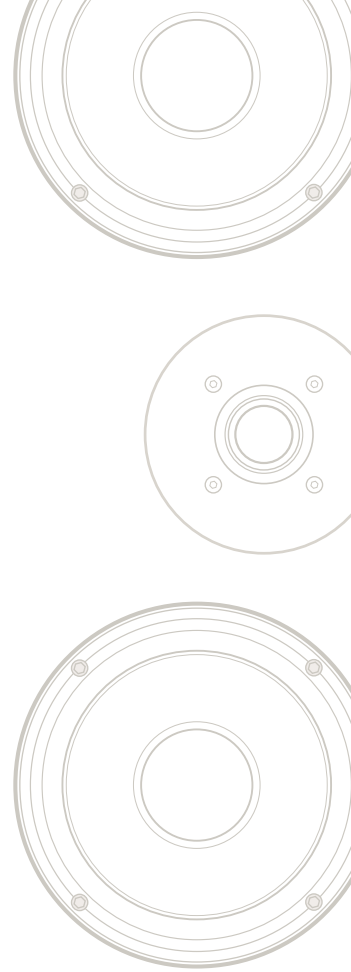



LIVING VOICE

A message from Kevin Scott

Thank you for purchasing this fine pair of loudspeakers. When used with appropriate ancillary equipment, the Living Voice R25A will provide many years of musical enjoyment.

The following guidelines will help you to achieve the best results.

Kevin Scott

DIRECTOR AND DESIGNER

LIVING VOICE

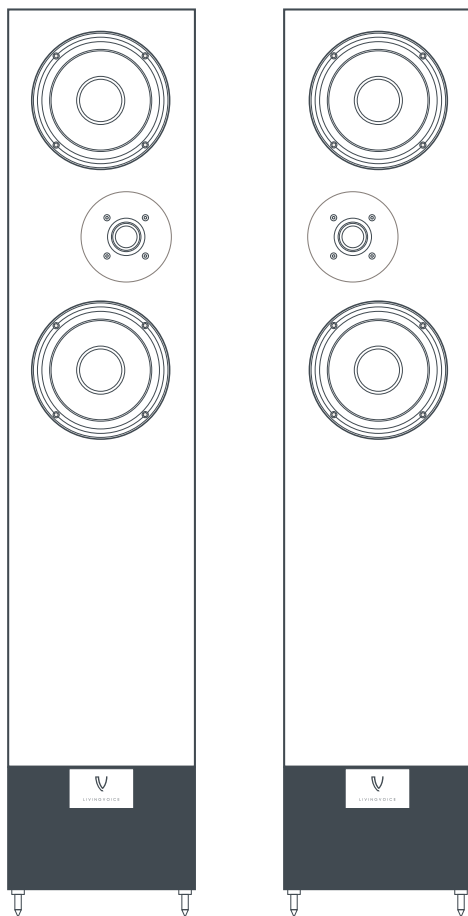

LEFT

RIGHT

UNBOXING AND ASSEMBLY

Carefully remove the loudspeakers and plinths from the packaging and identify the left and right units. You can distinguish the left and right cabinets by observing the position of the high frequency drive units. These are offset towards the centre: i.e. on the right-hand speaker cabinet the High Frequency unit is offset to the left, and on the left-hand speaker cabinet the High Frequency unit is offset to the right. (Retain the packaging if possible, and store in a dry place for potential future use)

Fix the spikes and locking nuts to the underside of the stands. Adjust the spikes so that the plinths are level on the floor. Do not over-tighten the locking nuts on the spikes. Slightly more than 'finger tight' is sufficient.

Place four pieces of 'Blu Tack' (provided), each about the size of a garden pea, on the top of each corner of the stands. Carefully place the speakers on the plinths and exert a downward pressure to bond them to the stands. After a few days the plinths and speakers will usually be so well bonded together that they will not separate easily.

However, care must be taken when moving the speakers so that should the plinths become loose they do not cause damage or injury.

CONNECTIONS

The high frequency and bass/mid input terminals are both colour-coded red and black. Connect these to your amplifier using a high quality speaker cable. It is preferable to use a bi-wired speaker cable set, however, if you need to single wire you must bridge the 2 red terminals together, and bridge the 2 black terminals together.

LISTENING POSITION & SET-UP

The tonal balance of any loudspeaker system is affected by the room in which it is used, and proximity to room boundaries is the key issue. Try to position the left and right speakers at the same distance from the back wall.

Using the speakers too close to the back wall can cause the bass performance to be big and boomy. A sensible starting point is 18" between the wall and the back of the speaker. You can try moving them closer or further from the back wall at a later stage.

Position the speakers so that the horizontal axes of the High Frequency units cross before your usual listening distance. This may mean that the cabinets are toed-in by 45 degrees in some circumstances. This configuration will give good depth of field.

Remember, what you want to achieve is:

- a] A natural overall tonal balance – adjust this with position relative to the back wall.
- b] A naturally proportioned stereo presentation – adjust this by moving the speakers either closer together or further apart and by adjusting the angle of toe-in.

All Living Voice loudspeakers need a period of use before they reach their optimum performance, due to the high quality of the components used. It can take up to 200 hours playing time to reach their full performance potential, although you will begin to hear a difference after 30 hours. It can sometimes be helpful to re-adjust the speaker positioning after this 'run-in' period.

CARE

To clean your R25A speakers occasionally use a very soft lint-free or microfibre cloth.

Do NOT use cleaners that contain ammonia, strong solvents, or silicone-based polish. Use of such products will damage the finish of your speaker cabinets.

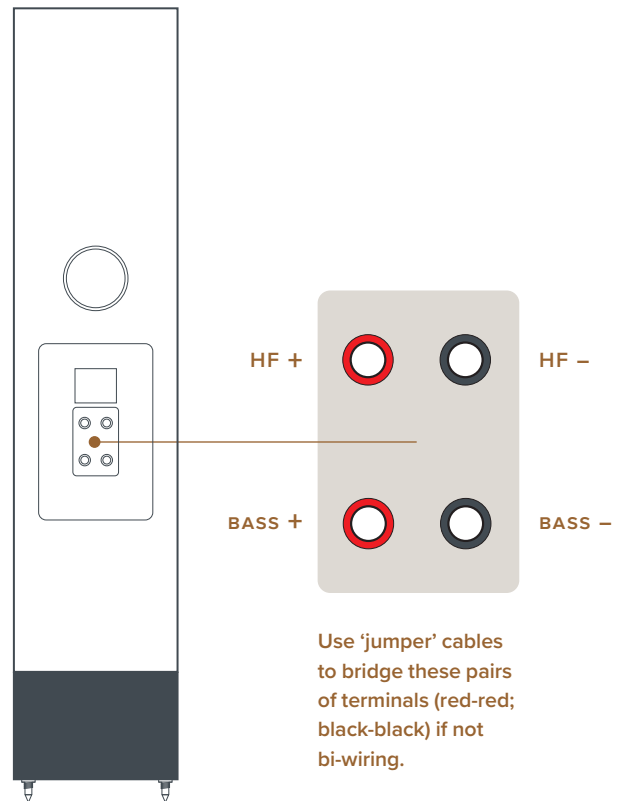

R25A

LIVING VOICE R25A WARRANTY

Thank you for purchasing this fine pair of Living Voice R25A loudspeakers. The R25A has been designed and manufactured to the highest quality standards and when used with appropriate ancillary equipment will provide many years of musical enjoyment. However, if something does go wrong with this product, Living Voice will warrant the replacement of defective parts including labour (exclusions may apply).

This warranty is valid for a period of 5 years from the date of purchase and is subject to the following requirements and understandings. Failure to observe these results in the warranty being immediately voided.

This warranty covers the Living Voice R25A loudspeakers. It does not affect your statutory rights.

Terms and conditions:

- The product must not be modified in any way, including the removal of drive units.
- The product must not be used or stored in a humid or insect infested environment, nor subject to outside weather, water, or salt spray.
- During the warranty period Living Voice or its appointed agent will repair the R25A loudspeaker to working order, or at Living Voice's option will replace a defective pair of R25A loudspeakers with a similar available product, at no extra cost to the owner including labour, materials, and shipping charges.
- Living Voice shall not, under any circumstances, be liable for any incidental or consequential damages arising from the loss of property or other damage or losses due to the failure of the R25A loudspeakers. Living Voice will not pay for damage caused to any other components caused by the failure of a pair of R25A within the limits allowed by national law.
- All repairs must be performed by an authorised service facility or by Living Voice.
- This product is only warranted in the country of original sale by Living Voice.
- This warranty is only valid for the original owner. It is not transferable. It is only valid when purchased from an authorised Living Voice dealer. A valid receipt with the purchaser's name, date of purchase, and dealer information must be submitted with all warranty cases.
- Living Voice can take no responsibility for loss or impairment to health and hearing through misuse of the R25A loudspeaker.
- All repairs performed after the warranty period has expired will be billed to the owner and will carry a 90-day warranty on and labour.



SPECIFICATIONS

SENSITIVITY
Sensitivity: 94dB

NOMINAL IMPEDANCE
6 ohms

MINIMUM/ MAXIMUM IMPEDANCE
4.2 ohms/ 9.5 ohms

LOADING
Reflex port to rear of cabinet.

POWER HANDLING
100 watts.

FREQUENCY RESPONSE
35 Hz to 22.5 kHz

CABINET DIMENSIONS
215mm W x 270mm D x 1030mm H.

PLINTH DIMENSIONS
215mm W x 270mm D x 140mm H.
Black textured finish.

GROSS WEIGHT
19kgs per cabinet

AVAILABLE FINISHES:
Cabinets made in premium furniture grade, book-matched veneers.
Cherry, Walnut, Maple, Rosenut, Matt Black, Flat White.

TECHNICAL SUMMARY

- High sensitivity, wide dispersion MTM driver topology.
- 750-density hardwood composite enclosure.
- Proprietary hand-wound air-core inductors, mechanically isolated crossover.
- Optimised crossover layout.
- Proprietary non-inductive wire-wound resistors.
- Proprietary Living Voice metallised polypropylene capacitors.
- H/F: Scanspeak D28mm fabric dome tweeter.
- Bass/Mid: Scanspeak 17cm doped paper coned drivers – made for Living Voice.

REGISTER ONLINE TO ACTIVATE YOUR WARRANTY

livingvoice.co.uk/warranty.html

T. +44 (0)115 973 3222 | F. +44 (0)115 973 3666 | E. shout@livingvoice.co.uk

STANHOPE HOUSE, HARRINGTON MILL, LONG EATON ENGLAND NG10 4QE